

PLASMA CUTTING

The new series of Torches
for plasma machine from 20A to 160A

TH-35 75°

TH-70 75°

TM-70 180°

TH-105 75°

TM-105 180°

TH-125 75°

TM-125 180°

UPH-160 75° Hybrid

UPM-160 180° Hybrid

● Higher performances

● Cleaner cut

● Faster speed

PLASMA CUTTING TORCHES

Technical Data

Built In Air Compressor

Current:	10-35 Amps
Duty Cycle:	35Amps 60%
Gas:	Air
Gas Pressure	
- Cutting:	50 PSI (3.5 bar)
Gas Flow at 35A:	190 scfh (90 lpm)
Post Flow Time :	40 sec minimum
Pilot :	Electrode to Tip (9-12A)
Ignition:	Without HF

Technical Data

External Air Compressor

Current:	10-35 Amps
Duty Cycle:	35Amps 100%
Gas:	Air/N2
Gas Pressure	
- Cutting:	72.5 PSI (5.0 bar)
Gas Flow at 35A:	235 scfh (110 lpm)
Post Flow Time :	30 sec minimum
Pilot :	Electrode to Tip (12-15A)
Ignition:	Without HF

For the correct operation please use:
 3-Ways Solenoid Valve, inside orifice
 2.5-3.0mm - (0.10-0.12inches)

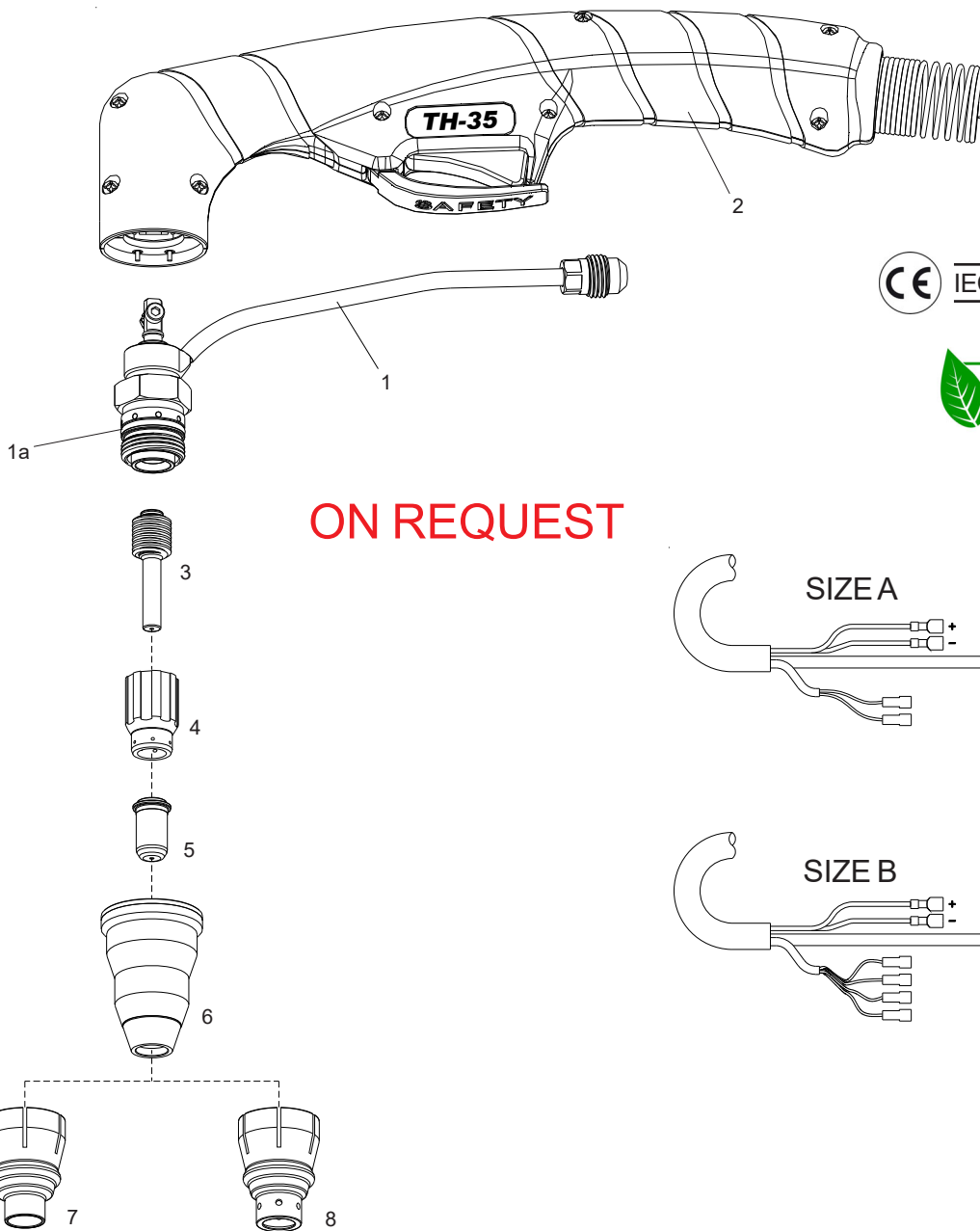

ON REQUEST

**Built in
Air Compressor**

**External
Air Compressor**

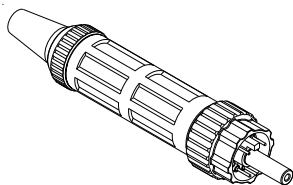
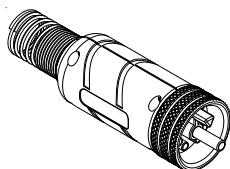
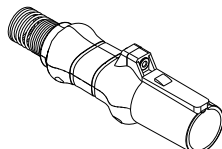
Air or N₂**TH-35 75°**
● **Standard Layout****Air Filter**
AT-1000**Standard**
Connection
Euro Connector**EASYFIT**
Connection
Patented**HY**
Connection
Patent Pending**Replacement Parts****Torch parts**

Item	Description	Code
1	● TH-35 75° Hand Torch Head	03601
1a	O-Ring	07300.60
2	Handle TH-35 75° complete with parts	03606
3	● Electrode	52573
4	● Swirl ring Maximum Life	60009
5	Tip, Contact Cutting, 20A	51218.06
	● Tip, Contact Cutting, 35A	51218
6	● Shield Cup Body	60302T
7	● Shield Cap, "Built in Air Compressor"	51955
8	● Shield Cap, "External Air Compressor"	51954

Accessories

Item	Description	Code
N/S	Circle Cutting Attachment	51844
9	BEVEL TOOL	51888

Complete Torches

	Description	Code
A	TH-35 75° Hand Torch, 4m (12.5 ft) Leads, Rubber Cable	03620C-4
A	TH-35 75° Hand Torch, 6m (20 ft) Leads, Rubber Cable	03620C-6
B	TH-35 75° Hand Torch, 4m (12.5 ft) Leads, Rubber Cable	03619C-4
B	TH-35 75° Hand Torch, 6m (20 ft) Leads, Rubber Cable	03619C-6
Euro	TH-35 75° Hand Torch, 4m (12.5 ft) Leads, Rubber Cable	03621C-4
Euro	TH-35 75° Hand Torch, 6m (20 ft) Leads, Rubber Cable	03621C-6

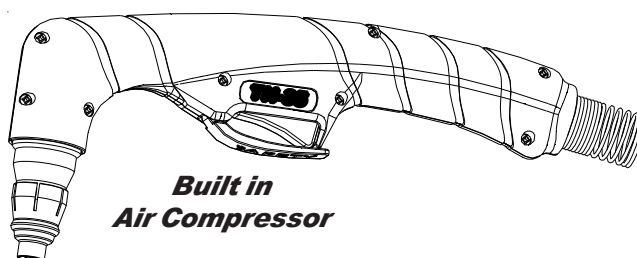
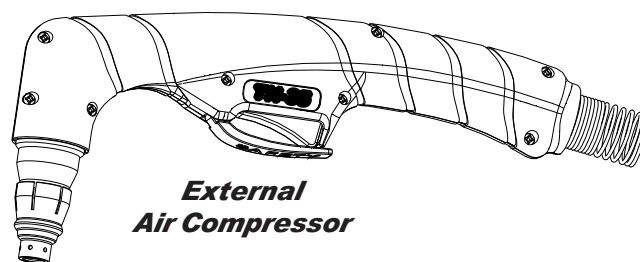
**Built in**
Air Compressor**External**
Air Compressor

Torches with different connectors available on request.

PLASMA CUTTING TORCHES

Technical Data

Current: 20-70 Amps
 Duty Cycle: 70 Amps 50%
 Gas: Air/N2
 Gas Pressure
 - Cutting: 72-80 PSI (5.0-5.5 bar)
 - Gouging: 58-65 PSI (4.0-4.5 bar)
 Gas Flow at 70A: 390 scfh (185 lpm)
 Post Flow Time : 45 sec
 Pilot : Electrode to Tip (12-15A)
 Ignition: Without HF

For the correct operation please use:
 3-Ways Solenoid Valve, inside orifice
 3.5-4.0mm - (0.138-0.157 inches)

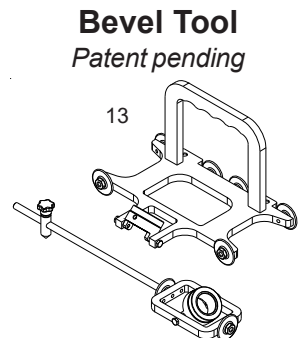
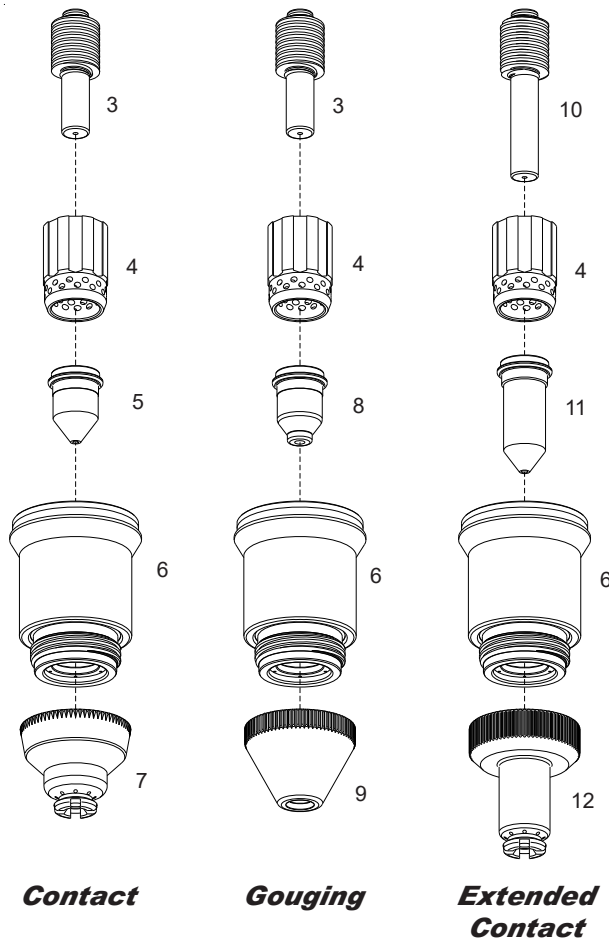
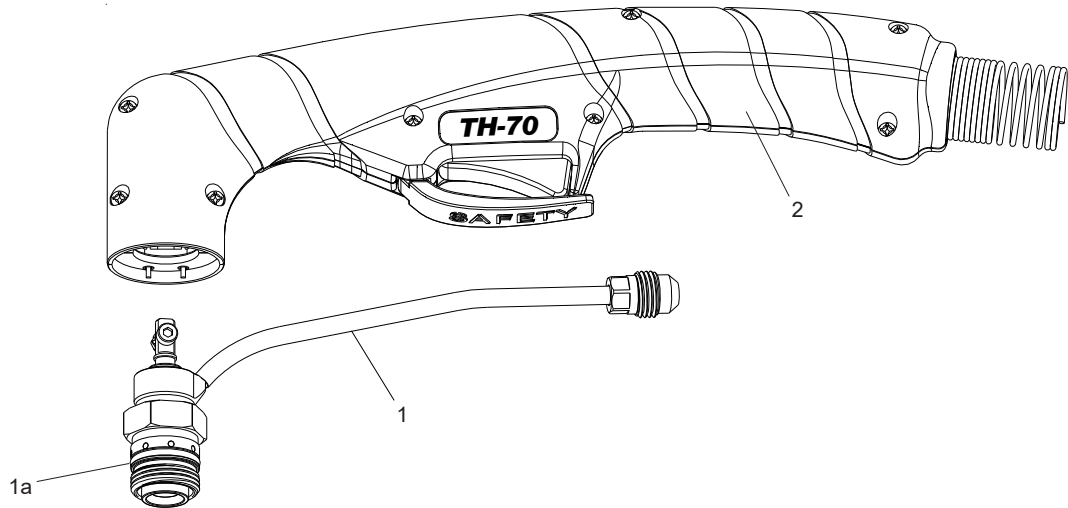

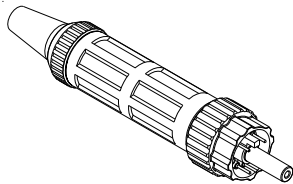
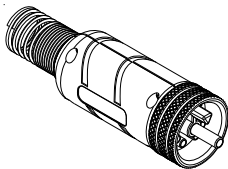
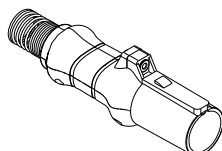
Air or N₂**TM-70eco**● **Standard Layout****TH-70**● **Standard Layout****Air Filter
AT-1000****Standard
Connection
Euro Connector****EASYFIT
Connection
Patented****HY
Connection
Patent Pending****Replacement Parts****Torch parts**

Item	Description	Code
1	● ● TH-105 75° Hand Torch Head	03600
1a	O-Ring	07300.60
2	Handle TH-105 75° complete with parts	03606
3	● ● Electrode, 20-70A	52574
4	● ● Swirl ring, 20-70A ECO	60041E
	● Swirl ring, 20-70A Maximum Life	60041
5	Tip, Contact Cutting, 20-50A	51206
	● ● Tip, Contact Cutting, 70A	51206.11
6	● ● Shield Cup Body, 20-70A ECO	60305TE
	● Shield Cup Body, 20-70A Maximum Life	60305T
7	● ● Shield Cap, 20-70A Hand	51923
8	Tip, Gouging, 45A	51206G
	Tip, Gouging, 70A	51206G.10
9	Shield Cap, 20-70A Gouging	51924G
10	Extended Electrode, 20-105A	52574L
11	Extended Shielded Tip, Contact Cutting, 20-50A	51206L
	Extended Shielded Tip, Contact Cutting, 70A	51206L.11
12	Extended Shield Cap, 20-70A Hand	51923L

Accessories

Item	Description	Code
N/S	Circle Cutting Attachment	51865
13	BEVEL TOOL	51880

Complete Torches ECO

TH-70 ECO 75° Hand Torch, 6m (20 ft) Leads,
Rubber Cable, Euro Connector. 03621-6

TH-70 ECO 75° Hand Torch, 12m (40 ft) Leads,
Rubber Cable, Euro Connector. 03621-12

Complete Torches Maximum Life

TH-70 75° Hand Torch, 6m (20 ft) Leads,
Coaxial Cable, Euro Connector. 03621CX

TH-70 75° Hand Torch, 12m (40 ft) Leads,
Coaxial Cable, Euro Connector. 03626CX

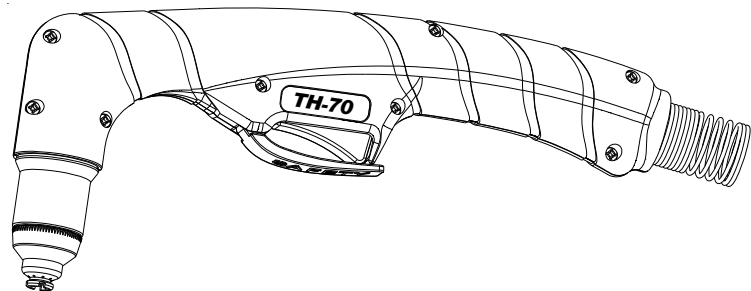

Torches with different connectors available on request.

PLASMA CUTTING TORCHES

Technical Data

Current: 20-70 Amps
 Duty Cycle: 70 Amps 50%
 Gas: Air/N2
 Gas Pressure
 - Cutting: 72-80 PSI (5.0-5.5 bar)
 - Gouging: 58-65 PSI (4.0-4.5 bar)
 Gas Flow at 70A: 390 scfh (185 lpm)
 Post Flow Time : 45 sec
 Pilot : Electrode to Tip (12-15A)
 Ignition: Without HF

For the correct operation please use:
 3-Ways Solenoid Valve, inside orifice
 3.5-4.0mm - (0.138-0.157 inches)

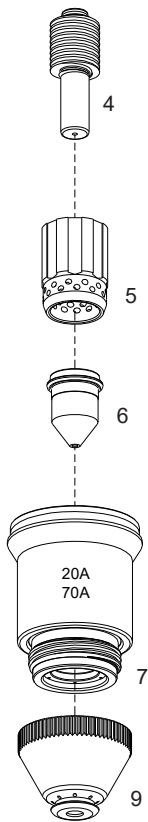

20-70A

Shielded

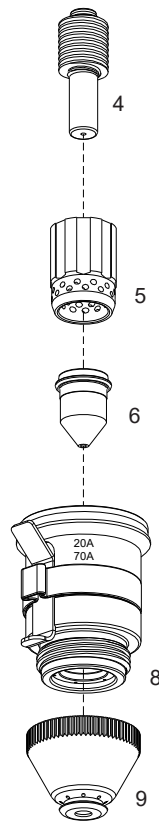

20-70A

Shielded with ohmic

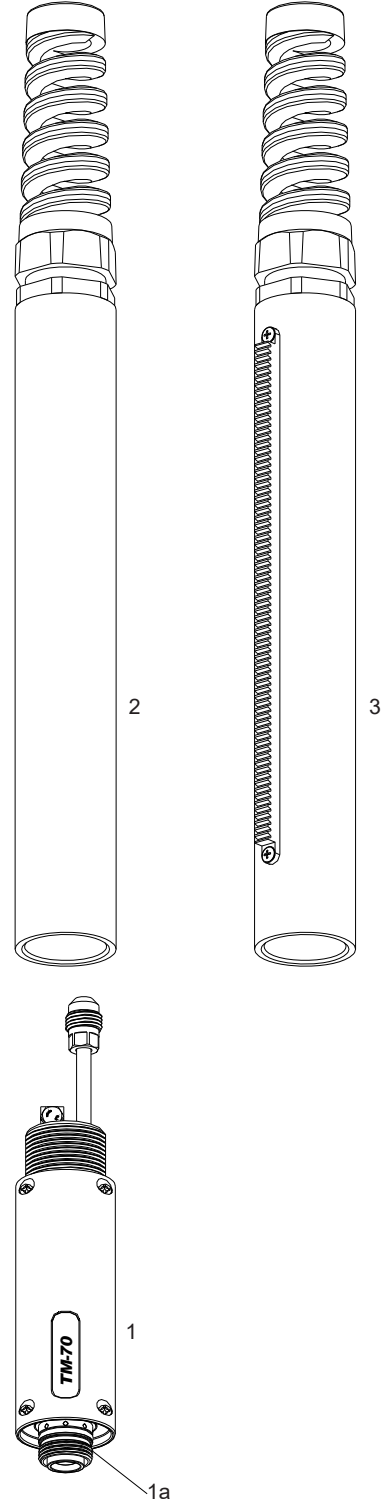

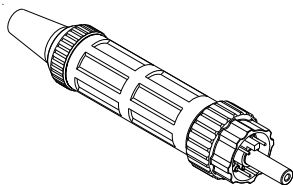
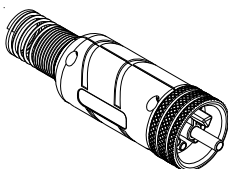
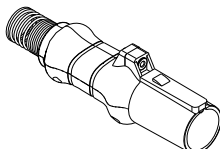
Air or N₂**TM-70eco**● **Standard Layout****TM-70**● **Standard Layout****Air Filter
AT-1000****Standard
Connection
Euro Connector****EASYFIT
Connection
Patented****HY
Connection
Patent Pending****Replacement Parts****Torch parts**

Item	Description	Code
1 ● ●	TM-70 180° Machine Torch Head	03610
1a	O-Ring	07300.60
2 ● ●	Fiberglass Positioning Tube	07218
3	Fiberglass Positioning Tube With Rack	07219
4 ● ●	Electrode, 20-70A	52574
5 ● ●	Swirl ring, 20-70A ECO	60041E
	● Swirl ring, 20-70A Maximum Life	60041
6	Tip, Contact Cutting, 20-50A	51206
	● ● Tip, Contact Cutting, 70A	51206.11
7 ● ●	Shield Cup Body, 20-70A ECO	60305TE
	● Shield Cup Body, 20-70A Maximum Life	60305T
8	Shield Cup Body Ohmic , 20-70A ECO	60305THE
	Shield Cup Body Ohmic , 20-70A Maximum Life	60305TH
9 ● ●	Shield Cap, 20-70A Machine	51924

CompleteTorches ECO

TM-70 ECO 180° MachineTorch, 6m (20 ft) Leads,
Rubber Cable, Euro Connector.

03631-6

TM-70 ECO 180° MachineTorch, 12m (40 ft) Leads,
Rubber Cable, Euro Connector.

03631-12

CompleteTorches Maximum Life

TM-70 180° MachineTorch, 6m (20 ft) Leads,
Coaxial Cable, Euro Connector.

03631CX

TM-70 180° MachineTorch, 12m (40 ft) Leads,
Coaxial Cable, Euro Connector.

03636CX

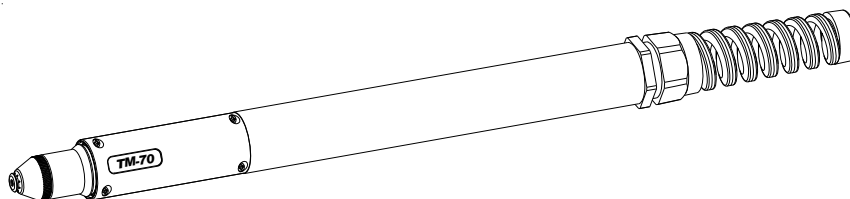

Torches with different connectors available on request.

PLASMA CUTTING TORCHES

Technical Data

Current: 20-105 Amps
 Duty Cycle: 105 Amps 60%
 Gas: Air/N2
 Gas Pressure
 - Cutting: 72-80 PSI (5.0-5.5 bar)
 - Gouging: 50-65 PSI (3.5-4.5 bar)
 Gas Flow at 105A: 510 scfh (240 lpm)
 Post Flow Time : 45 sec
 Pilot : Electrode to Tip (12-15A)
 Ignition: Without HF

For the correct operation please use:
 3-Ways Solenoid Valve, inside orifice
 3.5-4.0mm - (0.138-0.157 inches)

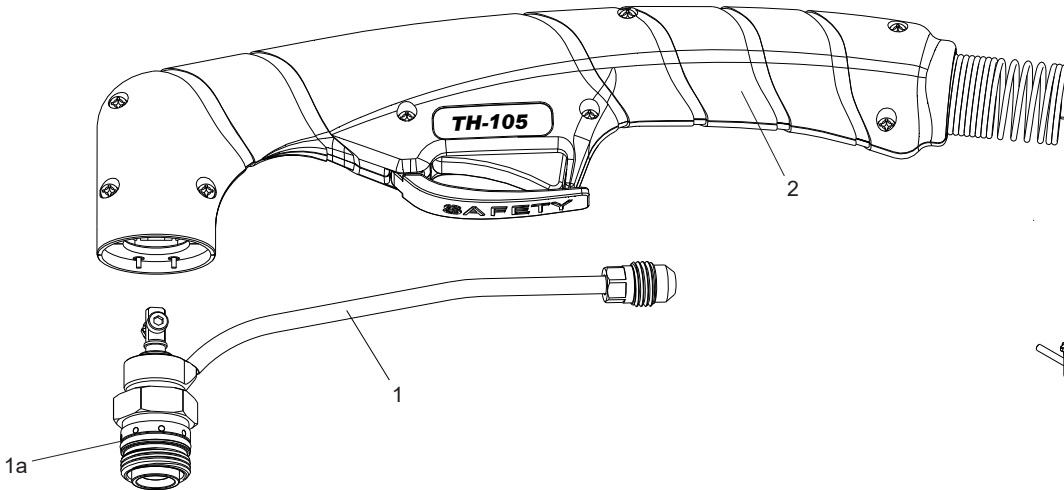

Bevel Tool
 Patent pending

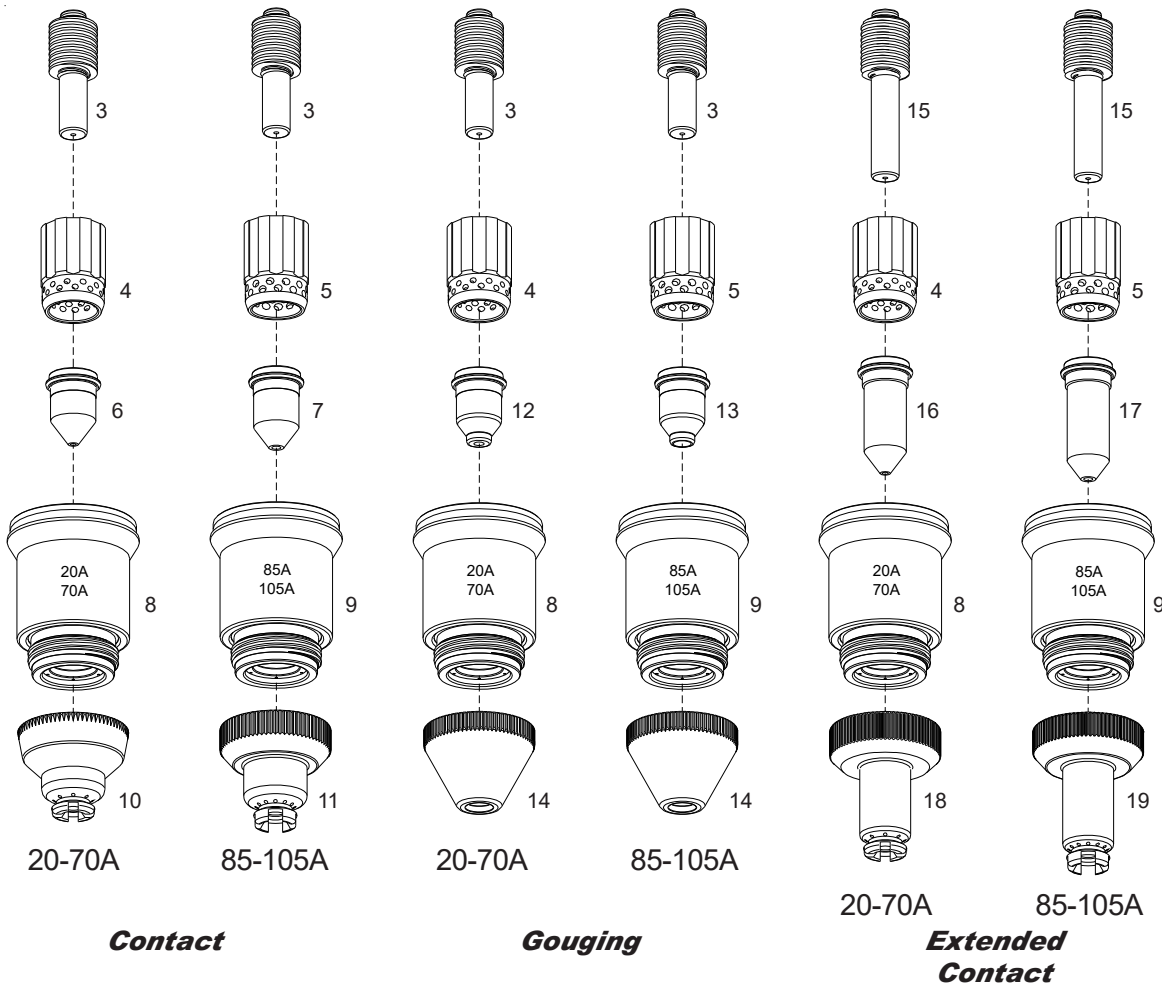
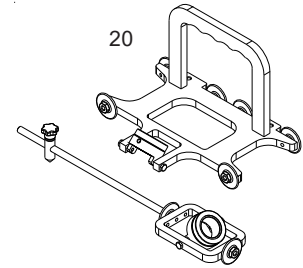

Air or N₂**TH-105eco**

- **Standard Layout**

TH-105

- **Standard Layout**

**Air Filter
AT-1000**



**Standard
Connection
Euro Connector**

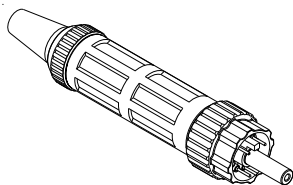

**EASYFIT
Connection
Patented**

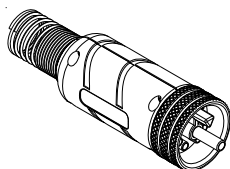

**HY
Connection
Patent Pending**

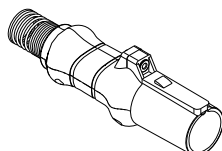
**Replacement Parts****Torch parts**

Item	Description	Code
1 ● ●	TH-105 75° Hand Torch Head	03600
1a	O-Ring	07300.60
2	Handle TH-105 75° complete with parts	03606
3 ● ●	Electrode, 20-105A	52574
4	Swirl ring, 20-70A ECO	60041E
	Swirl ring, 20-70A Maximum Life	60041
5 ●	Swirl ring, 85-105A ECO	60024E
	● Swirl ring, 85-105A Maximum Life	60024
6	Tip, Contact Cutting, 20-50A	51206
	Tip, Contact Cutting, 70A	51206.11
7	Tip, Contact Cutting, 85A	51223.13
	● ● Tip, Contact Cutting, 105A	51223.15
8	Shield Cup Body, 20-70A ECO	60305TE
	Shield Cup Body, 20-70A Maximum Life	60305T
9 ●	Shield Cup Body, 85-105A ECO	60329TE
	● Shield Cup Body, 85-105A Maximum Life	60329T
10	Shield Cap, 20-70A Hand	51923
11 ● ●	Shield Cap, 85-105A Hand	51941
12	Tip, Gouging, 45A	51206G
	Tip, Gouging, 70A	51206G.10
13	Tip, Gouging, 105A	51223G.14
14	Shield Cap, 20-105A Gouging	51924G
15	Extended Electrode, 20-105A	52574L
16	Extended Shielded Tip, Contact Cutting, 20-50A	51206L
	Extended Shielded Tip, Contact Cutting, 70A	51206L.11
17	Extended Shielded Tip, Contact Cutting, 85A	51223L.13
	Extended Shielded Tip, Contact Cutting, 105A	51223L.15
18	Extended Shield Cap, 20-70A Hand	51923L
19	Extended Shield Cap, 85-105A Hand	51941L

Accessories

Item	Description	Code
N/S	Circle Cutting Attachment	51865
20	BEVEL TOOL	51880

CompleteTorches ECO

TH-105 ECO 75° Hand Torch, 6m (20 ft) Leads,
Rubber Cable, Euro Connector. 02121-6

TH-105 ECO 75° Hand Torch, 12m (40 ft) Leads,
Rubber Cable, Euro Connector. 02121-12

CompleteTorches Maximum Life

TH-105 75° Hand Torch, 6m (20 ft) Leads,
Coaxial Cable, Euro Connector. 02121CX

TH-105 75° Hand Torch, 12m (40 ft) Leads,
Coaxial Cable, Euro Connector. 02126CX

Torches with different connectors available on request.

PLASMA CUTTING TORCHES

Technical Data

Current : 20-105 Amps
 Duty Cycle: 105 Amps 60%
 Gas: Air/N2
 Gas Pressure
 - Cutting: 72-80 PSI (5.0-5.5 bar)
 - Gouging: 50-65 PSI (3.5-4.5 bar)
 Gas Flow at 105A: 510 scfh (240 lpm)
 Post Flow Time : 45 sec
 Pilot : Electrode to Tip (12-15A)
 Ignition: Without HF

For the correct operation please use:
 3-Ways Solenoid Valve, inside orifice
 3.5-4.0mm - (0.138-0.157 inches)

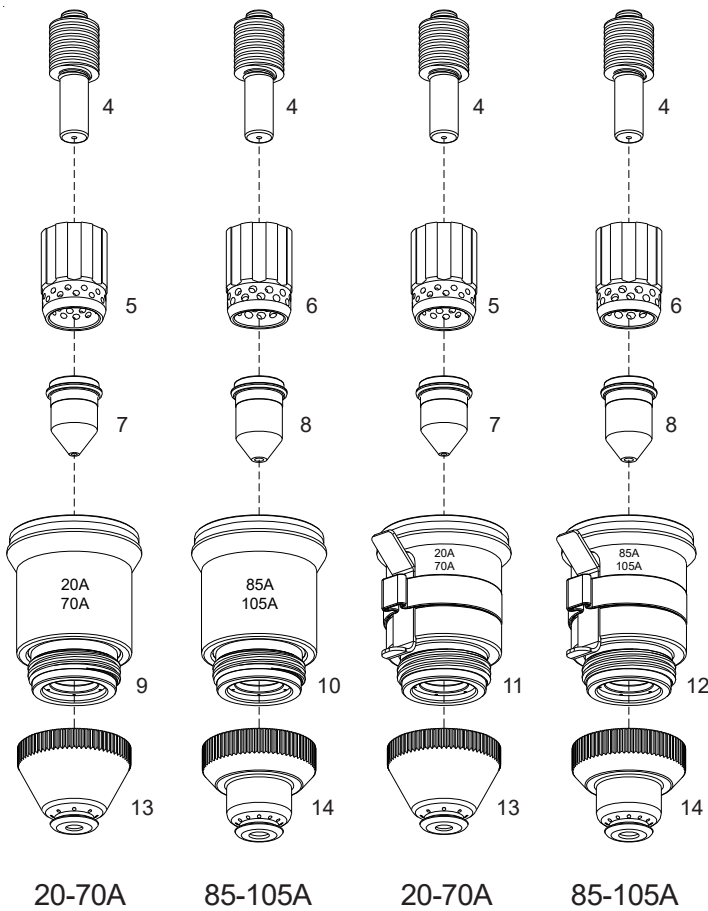

Shielded

Shielded with ohmic

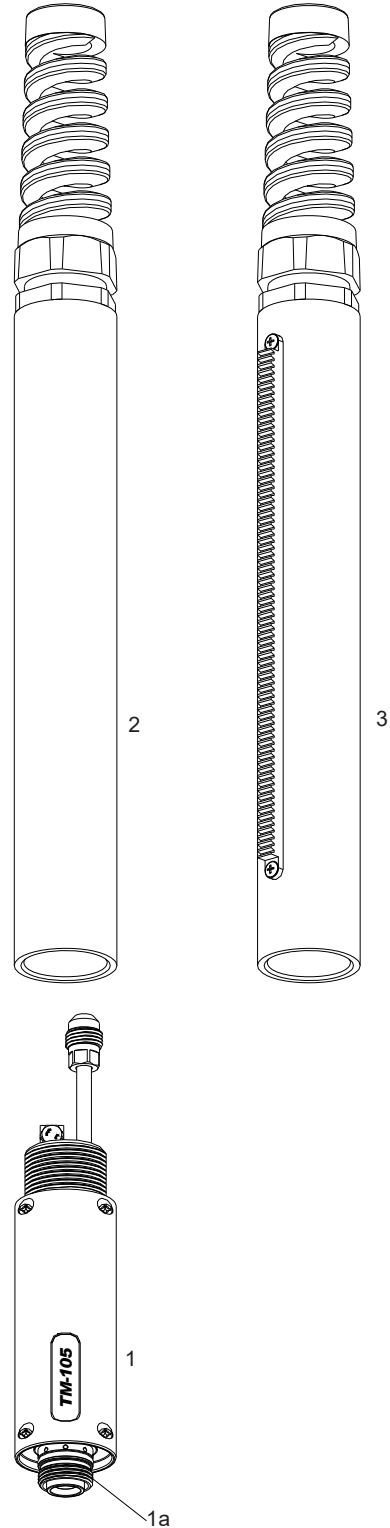

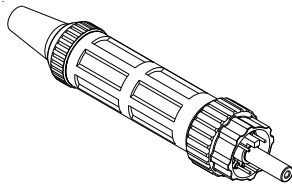
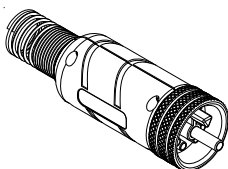
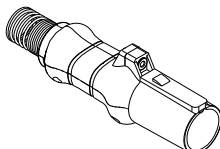
Air or N₂**TM-105eco**● **Standard Layout****TM-105**● **Standard Layout****Air Filter
AT-1000****Standard
Connection
Euro Connector****EASYFIT
Connection
Patented****HY
Connection
Patent Pending****Replacement Parts****Torch parts**

Item	Description	Code
1 ● ●	TM-105 180° Machine Torch Head	03610
1a	O-Ring	07300.60
2 ● ●	Fiberglass Positioning Tube	07218
3	Fiberglass Positioning Tube With Rack	07219
4 ● ●	Electrode, 20-105A	52574
5	Swirl ring, 20-70A ECO	60041E
	Swirl ring, 20-70A Maximum Life	60041
6 ●	Swirl ring, 85-105A ECO	60024E
	Swirl ring, 85-105A Maximum Life	60024
7	Tip, Contact Cutting, 20-50A	51206
	Tip, Contact Cutting, 70A	51206.11
8	Tip, Contact Cutting, 85A	51223.13
● ●	Tip, Contact Cutting, 105A	51223.15
9	Shield Cup Body, 20-70A ECO	60305TE
	Shield Cup Body, 20-70A Maximum Life	60305T
10 ●	Shield Cup Body, 85-105A ECO	60329TE
	Shield Cup Body, 85-105A Maximum Life	60329T
11	Shield Cup Body Ohmic , 20-70A ECO	60305THE
	Shield Cup Body Ohmic , 20-70A Maximum Life	60305TH
12	Shield Cup Body Ohmic , 85-105A ECO	60329THE
	Shield Cup Body Ohmic , 85-105A Maximum Life	60329TH
13	Shield Cap, 20-70A Machine	51924
14 ● ●	Shield Cap, 85-105A Machine	51942

CompleteTorches ECO

TM-105 ECO 180° MachineTorch, 6m (20 ft) Leads,
Rubber Cable, Euro Connector. 02131-6

TM-105 ECO 180° MachineTorch, 12m (40 ft) Leads,
Rubber Cable, Euro Connector. 02131-12

CompleteTorches Maximum Life

TM-105 180° MachineTorch, 6m (20 ft) Leads,
Coaxial Cable, Euro Connector. 02131CX

TM-105 180° MachineTorch, 12m (40 ft) Leads,
Coaxial Cable, Euro Connector. 02136CX

Torches with different connectors available on request.

PLASMA CUTTING TORCHES

Technical Data

Current : 40-125 Amps
 Duty Cycle: 125 Amps at 60%
 150 Amps at 40%
 Gas: Air/N2
 Gas Pressure
 - Cutting 125A: 72-87 PSI (5.0-6.0 bar)
 - Cutting 150A: 80-87 PSI (5.5-6.0 bar)
 - Gouging: 58-65 PSI (4.0-4.5 bar)
 Gas Flow at 125A: 630 SCFH (295 lpm)
 Post Flow Time : 45 sec
 Pilot : Electrode to Tip (15-18A)
 Ignition: Without HF

For the correct operation please use:
 3-Ways Solenoid Valve, inside orifice
 4.5-5.5mm - (0.178-0.217 inches)

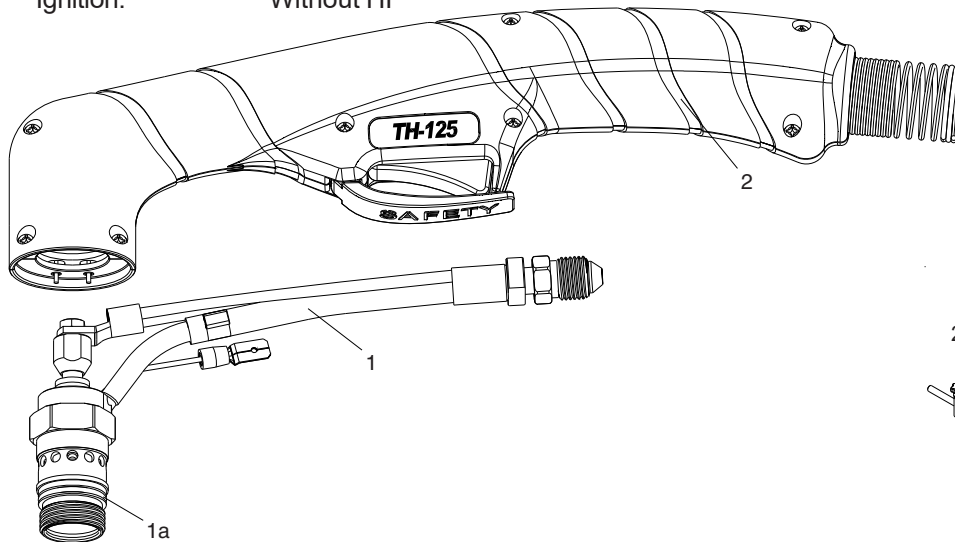

Bevel Tool
Patent pending

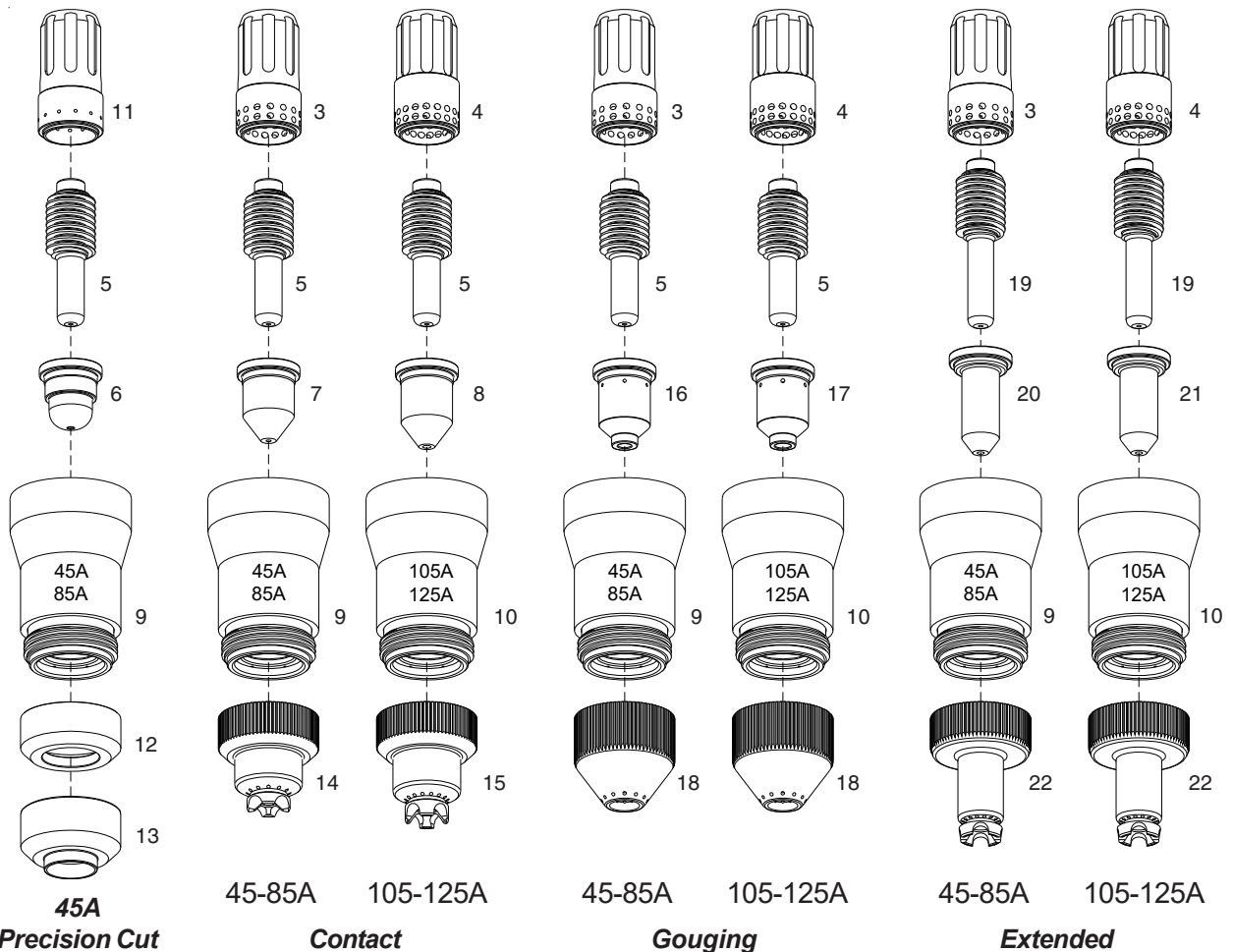
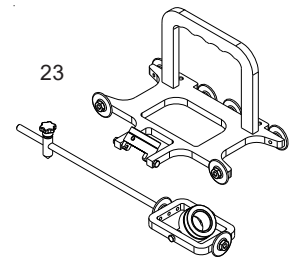

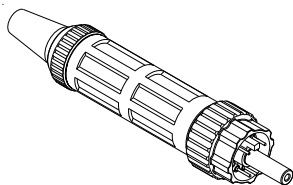
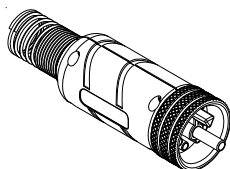
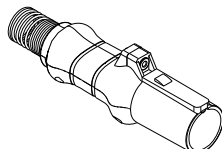
Air or N₂**TH-125eco**● **Standard Layout****TH-125**● **Standard Layout****Air Filter
AT-1000****Standard
Connection
Euro Connector****EASYFIT
Connection
Patented****HY
Connection
Patent Pending****Replacement Parts****Torch parts**

1	● ●	TH-125 75° Hand Torch Head	03700
1a		O-Ring	03700.60
2	● ●	Handle TH-125 75° complete with parts.	03705
3		Swirl ring, 45-85A ECO	60042E
		Swirl ring, 45-85A Maximum Life	60042
4	● ●	Swirl ring, 100-125A ECO	60040E
		Swirl ring, 100-125A Maximum Life	60040
5	●	Electrode, 45-125A	52677
6		Tip, Cutting, 45A Precision Cut	51415
7		Tip, Cutting, 45A	51416
		Tip, Cutting, 65A	51417
		Tip, Cutting, 85A	51418
8		Tip, Cutting, 105A	51419
	● ●	Tip, Cutting, 125A	51419.16
		Tip, Cutting, 150A	51419.18
9		Shield Cup Body, 45-85A ECO	60309EA
		Shield Cup Body, 45-85A Maximum Life	60309TA
10	● ●	Shield Cup Body, 100-125A ECO	60309EC
		Shield Cup Body, 100-125A Maximum Life	60309TC
11		Swirl ring, 45A, Precision Cut Maximum Life	60032
12		Deflector,	51928
13		Deflector, 45A Precision Cut	51931
14		Shield Cap, Hand, 45-85A	51921
15	● ●	Shield Cap, Hand, 100-125A	51926
16		Tip, Gouging, 65-85A	51417G
17		Tip, Gouging, 105A	51418G
		Tip, Gouging, 125A	51419G
18		Shield Cap, Gouging	51927G
19		Extended Electrode	52677L
20		Extended Tip, 65A	51417L.12
		Extended Tip, 85A	51417L.13
21		Extended Tip, 105A	51417L.15
		Extended Tip, 125A	51417L.17
22		Extended Shield 65-125A	51926L

Accessories

N/S	Circle Cutting Attachment	51865
23	BEVEL TOOL	51880

CompleteTorches ECO

TH-125 ECO 75° Hand Torch, 6m (20 ft) Leads,
Rubber Cable, Euro Connector 03721-6

TH-125 ECO 75° Hand Torch, 12m (40 ft) Leads,
Rubber Cable, Euro Connector 03721-12

CompleteTorches Maximum Life

TH-125 75° Hand Torch, 6m (20 ft) Leads,
Coaxial Cable, Euro Connector 03721CX

TH-125 75° Hand Torch, 12m (40 ft) Leads,
Coaxial Cable, Euro Connector 03726CX

Torches with different connectors available on request.

PLASMA CUTTING TORCHES

Technical Data

Current : 40-125 Amps
 Duty Cycle: 125 Amps at 60%
 Gas: Air/N2
 Gas Pressure
 - Cutting: 72-87 PSI (5.0-6.0 bar)
 - Gouging: 58-65 PSI (4.0-4.5 bar)
 Gas Flow at 125A: 630 SCFH (295 lpm)
 Post Flow Time : 45 sec
 Pilot : Electrode to Tip (15-18A)
 Ignition: Without HF

For the correct operation please use:
 3-Ways Solenoid Valve, inside orifice
 4.5-5.5mm - (0.178-0.217 inches)

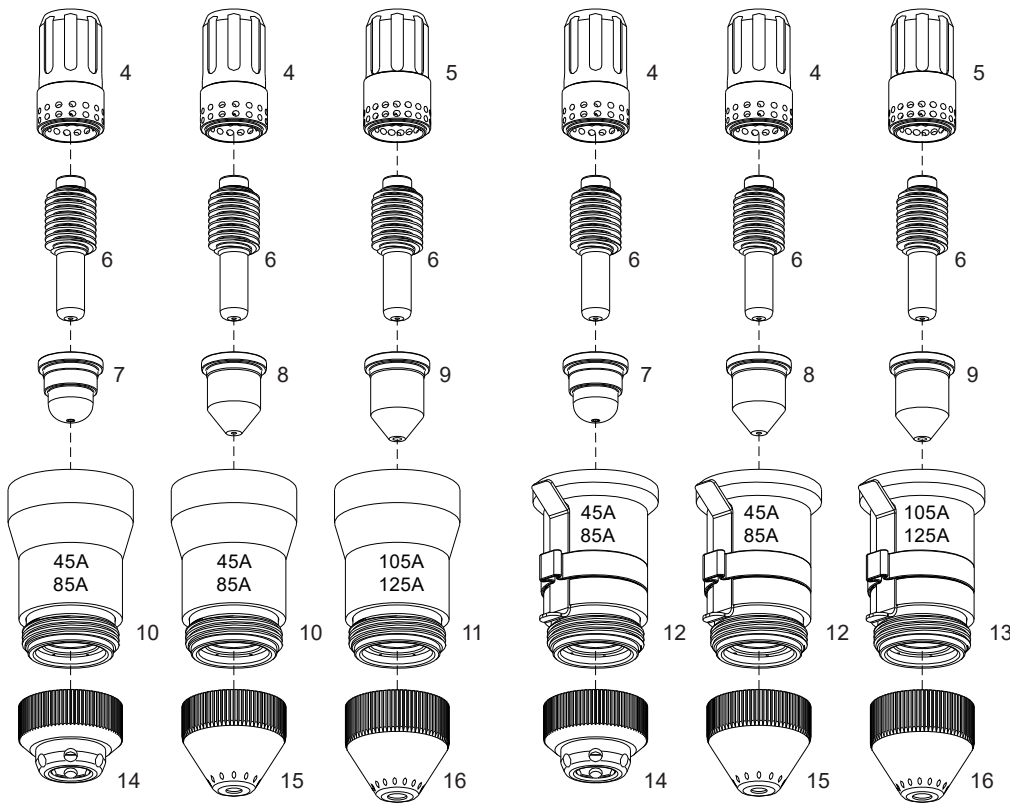

45A
Precision Cut

45-85A
Shielded

105-125A

45A
Precision Cut ohmic

45-85A
Shielded ohmic

105-125A

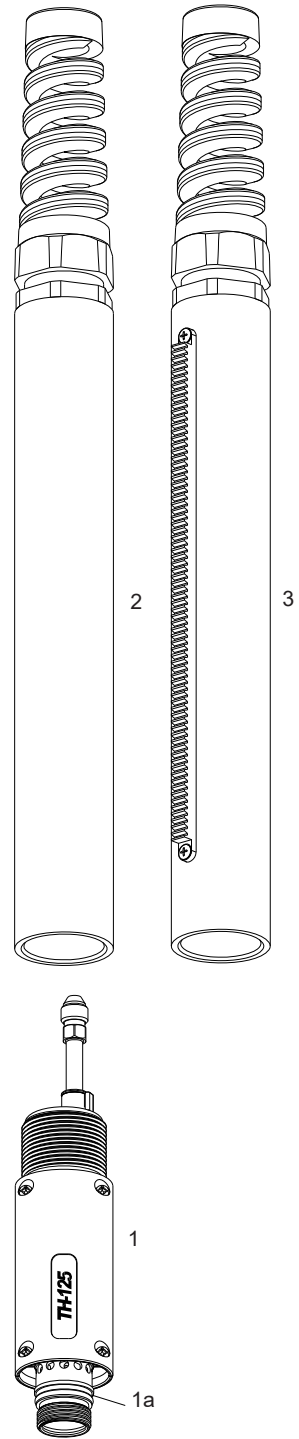

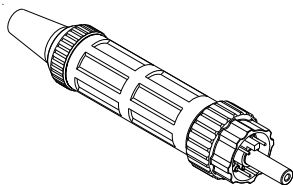
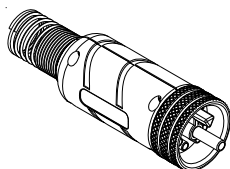
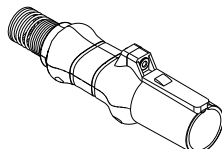
Air or N₂**TM-125eco**● **Standard Layout****TM-125**● **Standard Layout****Air Filter
AT-1000****Standard
Connection
Euro Connector****EASYFIT
Connection
Patented****HY
Connection
Patent Pending****Replacement Parts****Torch parts**

1	● ●	TM-125 180° Machine Torch Head	03710
1a		O-Ring	03700.60
2	● ●	Fiberglass Positioning Tube	07218
3		Fiberglass Positioning Tube With Rack	07219
4		Swirl ring, 45-85A ECO	60042E
		Swirl ring, 45-85A Maximum Life	60042
5	●	Swirl ring, 100-125A ECO	60040E
	●	Swirl ring, 100-125A Maximum Life	60040
6	● ●	Electrode, 45-125A	52677
7		Tip, Cutting, 45A Precision Cut	51415
8		Tip, Cutting, 45A	51416
		Tip, Cutting, 65A	51417
		Tip, Cutting, 85A	51418
9		Tip, Cutting, 105A	51419
	● ●	Tip, Cutting, 125A	51419.16
10		Shield Cup Body, 45-85A ECO	60309EA
		Shield Cup Body, 45-85A Maximum Life	60309TA
11	●	Shield Cup Body, 100-125A ECO	60309EC
	●	Shield Cup Body, 100-125A Maximum Life	60309TC
12		Shield Cup Body, 45-85A Ohmic ECO	60309EHA
		Shield Cup Body, 45-85A Ohmic Maximum Life	60309THA
13		Shield Cup Body, 100-125A Ohmic ECO	60309EHC
		Shield Cup Body, 100-125A Ohmic Maximum Life	60309THC
14		Shield Cap, 45A Precision Cut	51929
15		Shield Cap, Machine, 45-85A	51922
16	● ●	Shield Cap, Machine, 100-125A	51927

CompleteTorches ECO

TM-125 ECO 180° Machine Torch, 6m (20 ft) Leads,
Rubber Cable, Euro Connector 03731-6

TM-125 ECO 180° Machine Torch, 12m (40 ft) Leads,
Rubber Cable, Euro Connector 03731-12

CompleteTorches Maximum Life

TM-125 180° Machine Torch, 6m (20 ft) Leads,
Coaxial Cable, Euro Connector 03731CX

TM-125 180° Machine Torch, 12m (40 ft) Leads,
Coaxial Cable, Euro Connector 03736CX

Torches with different connectors available on request.

UPH-160

Hybrid

Technical Data

Current :	30-160 Amps
Duty Cycle:	160 Amps at 60%
Gas:	Air/N2
Gas Pressure	
- Cutting:	72-87 PSI (5.0-6.0 bar)
- Gouging:	40-46 PSI (3.0-3.5 bar)
Gas Flow at 160A:	850 SCFH (420 lpm)
Post Flow Time :	45 sec.
Pilot :	Electrode to Tip (22-25)
Ignition:	Without HF

For the correct operation please use:
 3-Ways Solenoid Valve, inside orifice
 4.5-5.5mm - (0.178-0.217 inches)

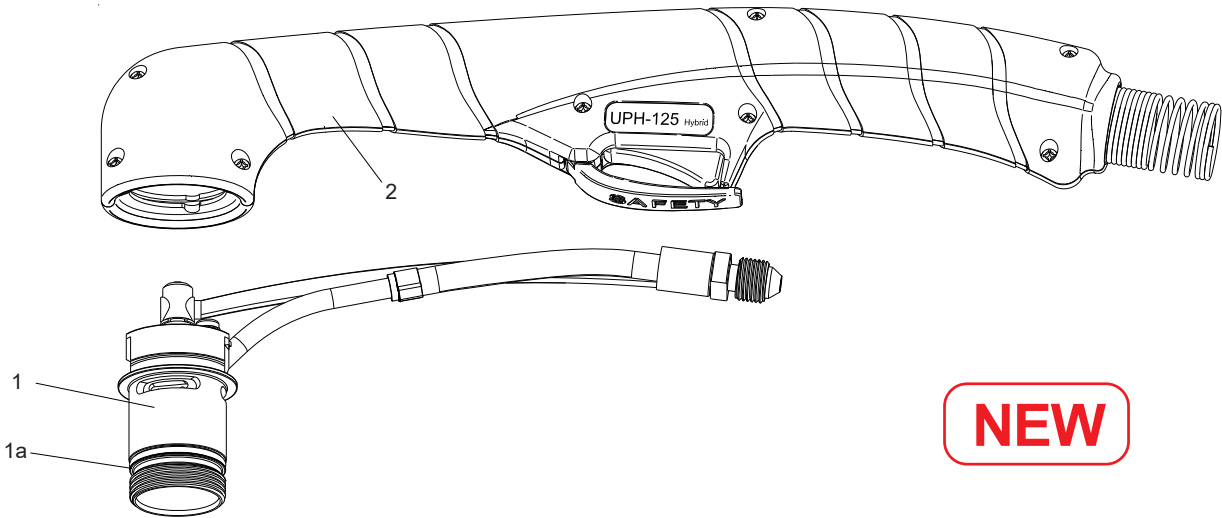

NEW

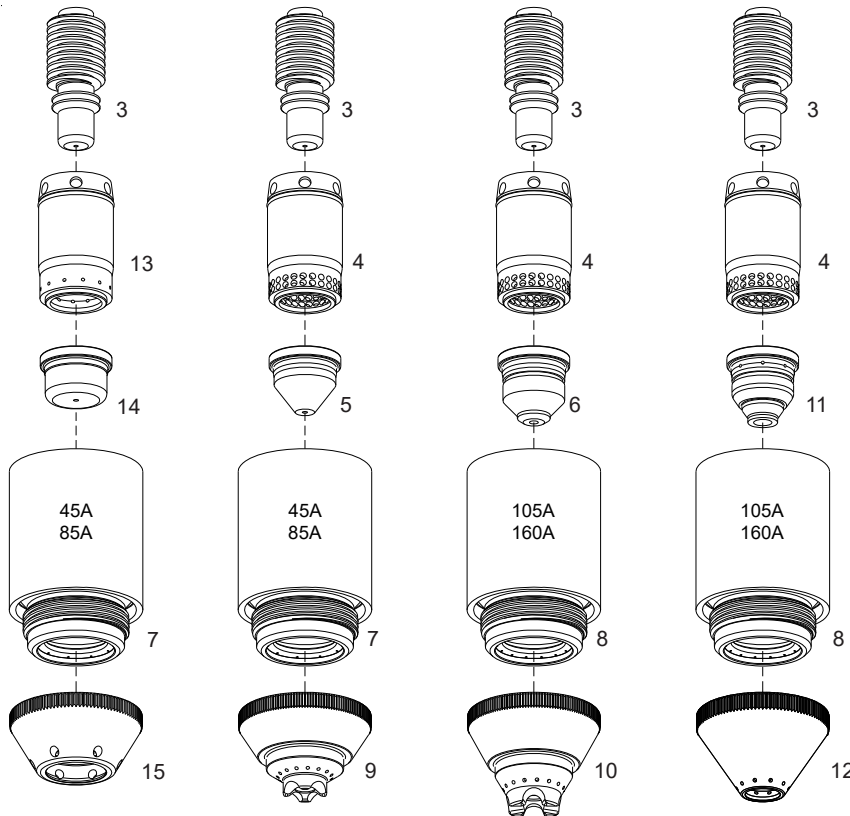

Patent pending

Bevel Tool
Patent pending

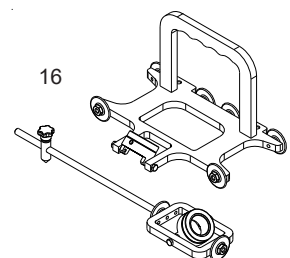

Precision Cut

Contact

Gouging

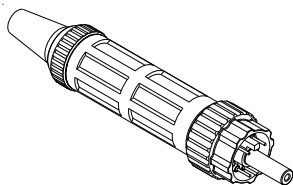
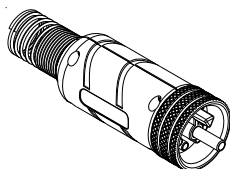
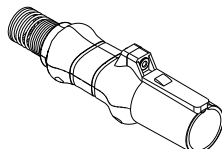
Air or N₂**UPH-160**
● **Standard Layout****Air Filter**
AT-1000**Standard**
Connection
Euro Connector**EASYFIT**
Connection
Patented**HY**
Connection
Patent Pending**Replacement Parts****Torch parts**

Item	Description	Code
1	● UPH-160 85° Hand Torch Head	03900
1a	● O-Ring	03900.60
2	● Handle UPH-160 85° complete with parts.	05505
3	● Electrode, Patent Pending Electrode, BiMetal , Patent Pending	52678 52678BM
4	● Swirl ring, Maximum Life Swirl ring, ECO	60039 60039E
5	Tip, Cutting, 45A	51420
	Tip, Cutting, 65A	51421
	Tip, Cutting, 85A	51422
6	Tip, Cutting, 105-125A	51425
	● Tip, Cutting, 160A	51426
7	Shield Cup Body, 45-85A	60311TA
8	● Shield Cup Body, 105-160A	60311TB
9	Shield Cap, Hand, 45-85A	51916T
10	● Shield Cap, Hand, 105-160A	51917T
11	Tip, Gouging, 105-125A	51424G
	Tip, Gouging, 160A	51425G
12	Shield Cap, Gouging	51919G
13	Swirl ring, Precision Cut (Hand Cutting)	60033
14	Tip, 30-45A, Precision Cut	51428
15	Deflector, Precision Cut	51915

Accessories

n/s	Circle Cutting Attachment	51868
16	BEVEL TOOL	51886

Complete Torches Maximum Life

UPH-160 85° Hand Torch, 6m (20 ft) Leads, Coaxial Cable , Euro Connector.	03921CX
UPH-160 85° Hand Torch, 12m (40 ft) Leads, Coaxial Cable , Euro Connector.	03926CX

Torches with different connectors available on request.

PLASMA CUTTING TORCHES

Technical Data

Current :	30-160 Amps
Duty Cycle:	160 Amps at 60%
Gas:	Air/N2
Gas Pressure	
- Cutting:	72-87 PSI (5.0-6.0 bar)
- Gouging:	40-46 PSI (3.0-3.5 bar)
Gas Flow at 160A:	850 SCFH (420 lpm)
Post Flow Time :	45 sec.
Pilot :	Electrode to Tip (22-25)
Ignition:	Without HF

For the correct operation please use:
 3-Ways Solenoid Valve, inside orifice
 4.5-5.5mm - (0.178-0.217 inches)



NEW

Patent pending

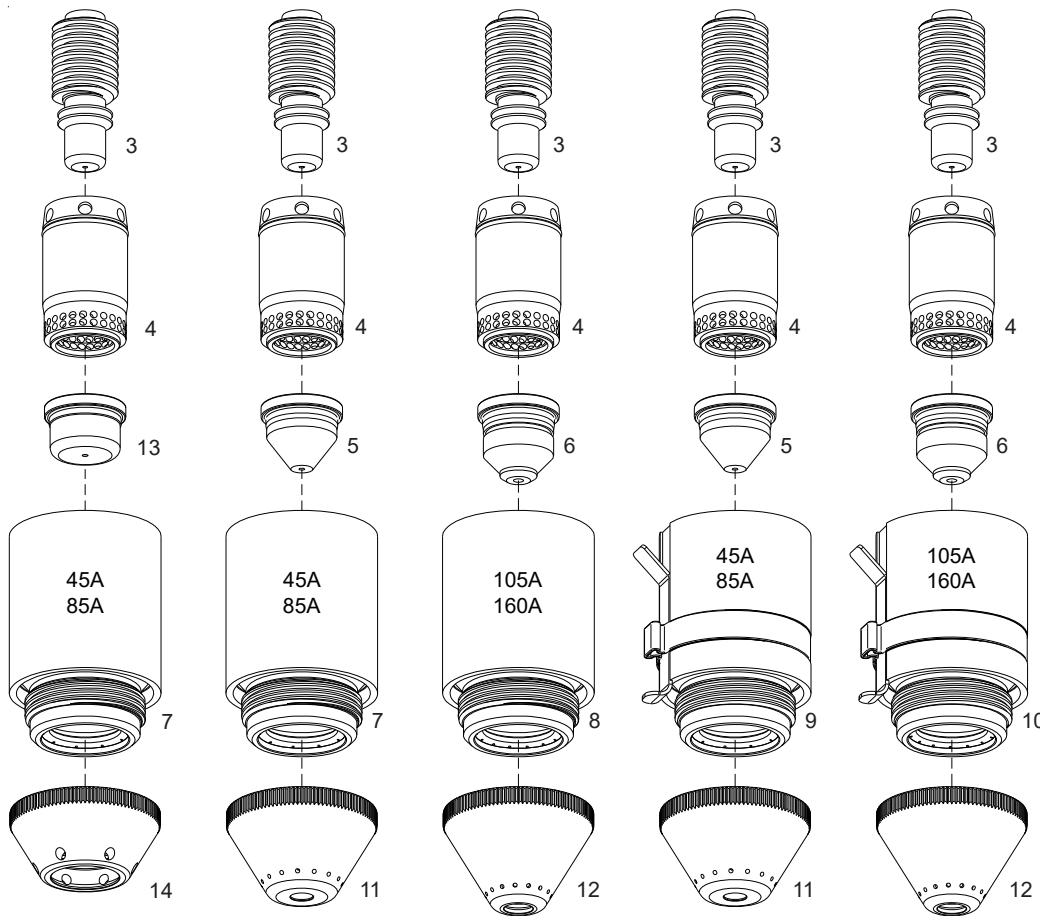

Precision Cut

Shielded

Shielded with ohmic

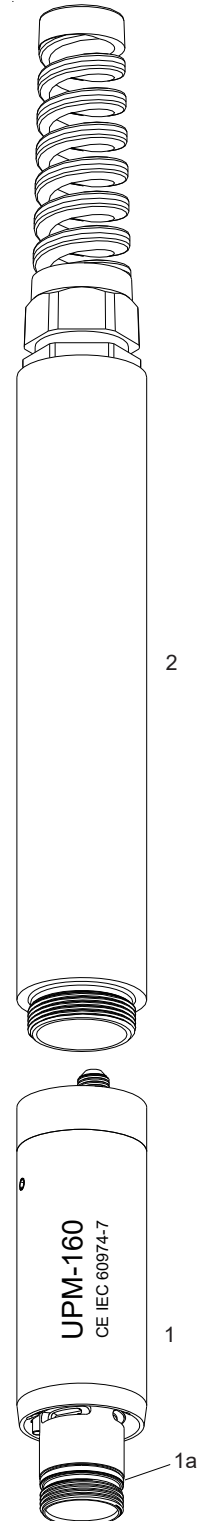

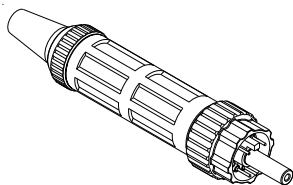
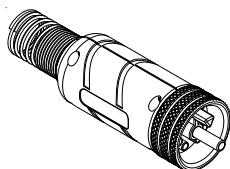
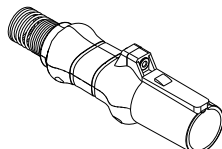
Air or N₂**UPM-160**
● **Standard Layout****Air Filter**
AT-1000**Standard**
Connection
Euro Connector**EASYFIT**
Connection
Patented**HY**
Connection
Patent Pending**Replacement Parts****Torch parts**

Item	Description	Code
1	● UPM-160 180° Machine Torch Head	03910
1a	● O-Ring	03900.60
2	● Fiberglass Positioning Tube	03916
3	● Electrode Patent Pending	52678
	Electrode, BiMetal, Patent Pending	52678BM
4	● Swirl ring, Maximum Life	60039
	Swirl ring, ECO	60039E
5	Tip, Cutting, 45A	51420
	Tip, Cutting, 65A	51421
	Tip, Cutting, 85A	51422
6	Tip, Cutting, 105-125A	51425
	● Tip, Cutting, 160A	51426
7	Shield Cup Body, 45-85A	60311TA
8	● Shield Cup Body, 105-160A	60311TB
9	Shield Cup Body, 45-85A Ohmic	60311THA
10	Shield Cup Body, 105-160A Ohmic	60311THB
11	Shield Cap, Machine, 45-85A	51918T
12	● Shield Cap, Machine, 105-160A	51919T
13	Tip, 30-45A, Precision Cut	51428
14	Deflector, Precision Cut	51915

Complete Torches Maximum Life

UPM-160 180° Machine Torch, 6m (20 ft) Leads,
Coaxial Cable, Euro Connector. 03931CX

UPM-160 180° Machine Torch, 12m (40 ft) Leads,
Coaxial Cable, Euro Connector. 03936CX

Torches with different connectors available on request.

PLASMA CUTTING TORCHES

AIR FILTER AT1000

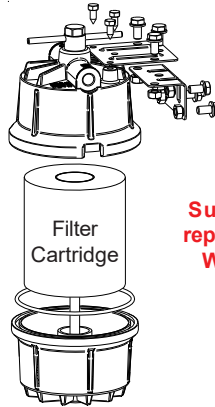

**Suggested
replacement:
WEEKLY**

Air Filter Complete Code: 50500

Packaging:

Air Filter AT1000

Code: 50500-12

Carton Box: 12 Filters

Dimensions: 11" x 16.5" x h. 17.3"
(cm 28 x 42 x h. 44)

Weight: 43 lbs (19.5 kg)

Filter Cartridge

Code: 50505-8

Carton Box: 8 Cartridges

Dimensions: 8.58" x 8.58" x h. 9.61"
(cm 21.8 x 21.8 x h. 24.4)

Weight: 4.2 lbs (1.9 kg)

Code: 50505-48

Master Box: 8x6=48 Cartridges

Dimensions: 17.72" x 26.38" x h. 10.43"
(cm 45 x 67 x h. 26.5)

Weight: 26.7 lbs (12.1 kg)

"AT 1000" is the perfect solution to the problems created by the contamination of the compressed air used in many plasma cutting systems.

It eliminates "sputter" caused by moisture and oil from compressed air lines.

It extends the electrode and nozzle life, with obvious benefits to the cut quality.

Designed to remove aerosol oil and moisture, "AT 1000" is a real benefit, entrapping particles as small as .01 microns inches.

With "AT 1000" torches last longer. Without this filter, at the end of this cutting session, inside the torch and torch head you have left condensed moisture, that can cause a short-circuit, with consequent rise of costs coming from the replacement of the torch head and the needed time to realize this operation.

"AT 1000" can filter up to 1250 liters a minute without reduction in pressure.

It's recommended to replace the filter cartridge every 5 to 7 days (max).

It's also very suitable for painters and use of pneumatic tools.

Our excellent knowhow in the production of plasma cutting torches and the consequent problems of air contaminant brought us to create the "AT 1000" being very effective and important for users of plasma cutting systems.

BEVEL TOOL

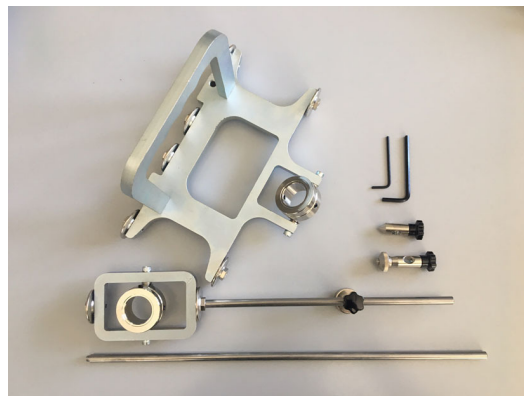

Code	Description
51880	TEC.MO.® TH-70/105/125
51886	TEC.MO.® UPH-160

CNC Plasma Water Table

Ask for more specific information



- Eliminates the need for the suction hood
- Preserve the cutting table technical and mobile parts from rust corrosion
- Solves the problem of rust in the finished piece
- Catches 98 % of fumes and dust
- Absorbs the majority of sparks

Plasma Fluid RI-MEC 100/PCF



Code	Description
50005	PLASMA FLUID RI-MEC 100/PCF (5 LT.) / 1 BOX FOR 4 PIECES / DIMENSIONS: 44x30xH30 (Kg. 20)

35+
years

TEC.MO.
=

Quality
Technology
Innovation